



*Lanhill Road, London, W9 2BS*  
*£350,000 Share of Freehold*









1 x  1 x  1 x 

A bright compact one bedroom flat set with a Victorian conversion on Lanhill Road with high ceilings, and some original cornice details. The accommodation comprises an open plan reception/kitchen and double bedroom, with tiled bathroom. Would suit a rental investor.

Offered with a share of freehold, the property presents an excellent opportunity for investors, as it is currently let on a two-year tenancy from February 2025, with a one-year break clause — providing immediate rental income and security.

Perfectly positioned between Maida Vale and Warwick Avenue underground stations, the flat is within easy reach of the vibrant cafés and shops of Little Venice, the open green spaces of Paddington Recreation Ground, and the scenic canal walks.



## Lanhill Road

Approx. Gross Internal Area  
261.24 Ft<sup>2</sup> - 24.27 M<sup>2</sup>

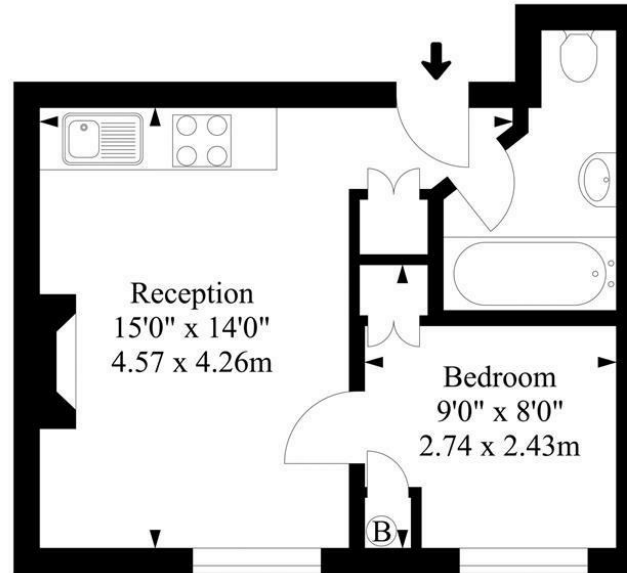
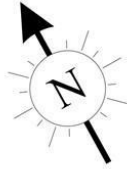

### First Floor

Illustration For Identification Purposes Only. Not To Scale

**Important Notice** Debussy Property Service Ltd trading as Braithwait for themselves and for the vendor of this property whose agents they are, give notice that (i) these particulars do not constitute any part of an offer or contract, (ii) all statements contained within these particulars are made without responsibility on the part of Braithwait or the vendor, (iii) whilst none in good faith, none of the statements contained within these particulars are to be relied upon as a statement of representation or fact, (iv) any intending purchaser must satisfy him/herself by inspection or otherwise as to the correctness of each of the statements contained within these particulars, (v) the vendor does not make or give either Braithwait or any person within their employment any authority to make or give any representation or warranty whatsoever in relation to this property. Wide angled lenses may be used in photographs.

Call us on 0207 289 8889 or email [sales@braithwait.co.uk](mailto:sales@braithwait.co.uk)

